

*Transhate*

## REMOTE MANUAL TYPE LUBRICATION SYSTEM

Remote manual greasing makes it possible to grease the pellet mill while in operation. Access to the main bearings and roll bearings is provided through a special drilled die pin - roller fork and roll pins.

Each roll pin is equipped with two "O" rings to provide a grease seal. Care should be taken when removing or installing the roll pin in the die pin - roller fork so as not to cut these rings. The standard roll pin will not work on a remote manual system because of the special drilling and the two "O" ring grooves required in each one.

Periodic inspection of the rolls should be made to assure that the "O" rings are sealing and grease is getting to the roll bearings.

When greasing the main bearings or roll bearings for the first time it is suggested that it be done with the mill shutdown so as to determine the amount of grease required. The amount of grease required and the time interval between greasings will vary with different applications and will have to be determined through experience. Enough grease should be added each time to flush through the front main bearing seal and through the roll bearing seal.



TRANSLATE.

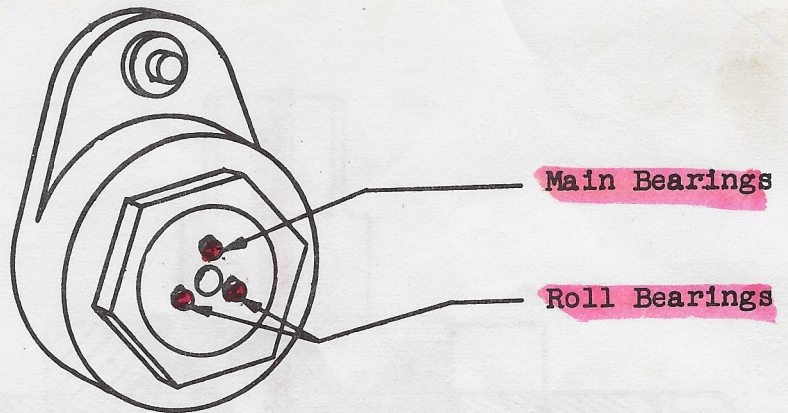

Grease Fittings for  
Remote Greasing

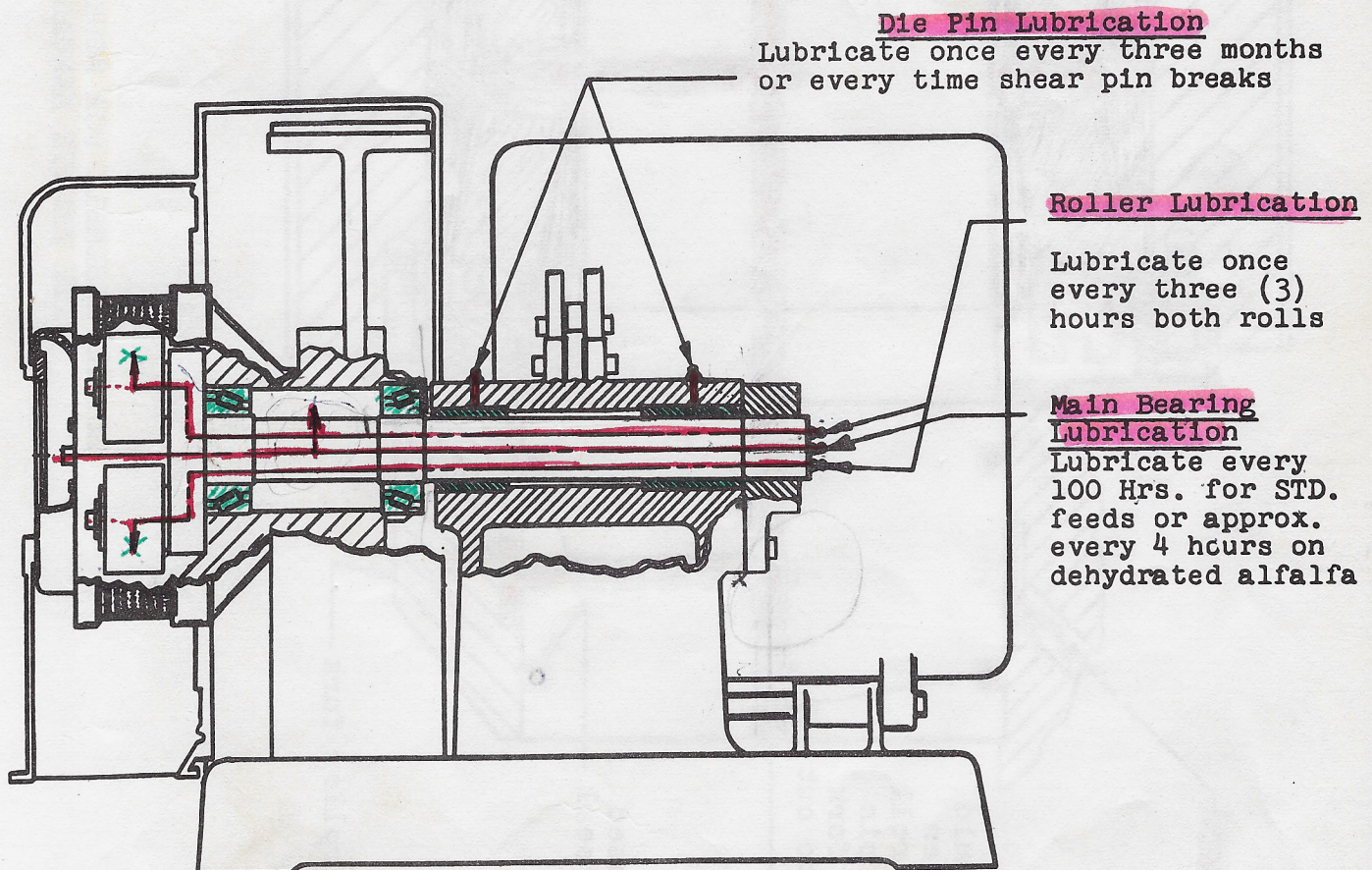

Lubricating Points on Pellet Mill  
Remote Manual Lubrication  
(Mill can be greased while running)



TRANSLATE

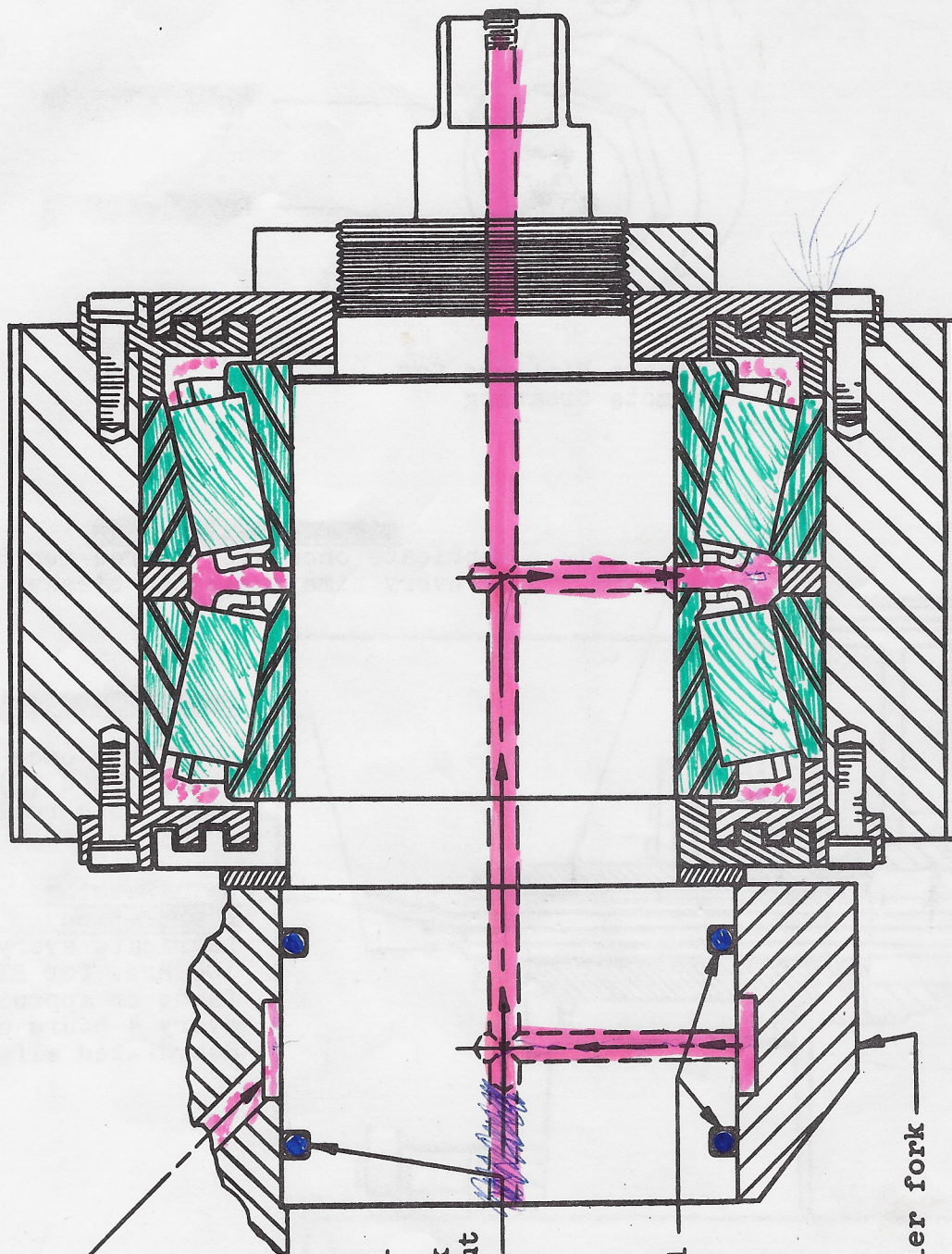

Grease Flow

Caution should be taken when installing roll pin in die pin and roller fork so as not to cut "O" ring

"O" rings used for grease seal

Die pin & roller fork

ROLLER ASSEMBLY FOR MODEL 501 PELLETER  
WITH REMOTE MANUAL GREASING





F-1948

CONFIDENTIAL - PROPERTY OF  
SPROUT, WALDRON & Co. INC. MUNCY, PA.

BY	NAME	DATE
DR	DES	3/9/73
CHECK		
APPRO		

SCALE:

CONFIDENTIAL - PROPERTY OF

# DRAWING FOR 93D MANUAL

7 MICRO-INCHES

DRAWING NUMBER  
D562-133

2

၄

A



PELLET MILL PARTS LIST

<u>ITEM NO.</u>	<u>DESCRIPTION</u>
1	Base, C.I. (dbl. eye bolt adj. on motor plate).
2	Bronze bushing (in base to hold die pin).
3	Ex-Cell-O head press fit bushing 0-655.
4	Alemite hydraulic grease fitting 1/8" pipe thread.
5	Micro switch support bracket.
6	Micro switch Type EXXR-3, explosion-proof.
7	Screw, hex head, 1/4 x 3/4 (Micro switch bracket).
8	Screw, #10-32 x 1/2 (Micro switch).
9	Combined die pin and roller fork assembly, cast steel (solid pin for standard lub.). <u>NOTE:</u> Item 9 assemblies include shaft seal ring, key, lub. seals, and fittings, and special collar screws.)
10	Special collar screw, 3/4-10 x 3-1/2" long.
12	Timken bearing cup #95925, Timken bearing cone #95500 (Main bearings for large bore die housing).
13	Die housing, cast steel (for large bearing).
14	Wear ring insert (die housing and cover).
15	Screw, socket head set 1/2 x 3/4" (to retain shear pin bushing).
16	Screw, square head set, Grade 5, 3/4 x 2-3/4" (Jack screw in die housing).
17	Alemite hydraulic grease fitting, 1/4" pipe thread (die housing main bearing).
18	45° Alemite hydraulic grease fitting, 1/4" pipe thread (die housing main bearing).
19	Bearing cover, front, C.I.
20	Garlock Klosure
21	Screw, SST socket head cap, 3/8" x 1" (bearing cover).
22	Bearing cover, rear, C.I. (large bearing die housing).
23	Bronze ring (use with Item 25).
24	Screw, socket head cap, 1/4" x 1".
25	Bearing adjusting ring, cast SST (adjust main bearings).
26	Shear pin collar, cast iron.
27	Key, 7/8 x 1-1/2 x 3" (shear pin collar).
28	Ex-Cell-O head press fit bushing 0-655, recessed.
29	Bolt, hex head, 3/4 x 5" (shear pin block).
29-A	Lockwasher, spg., Type 3/4" (for Item 29).
29-B	Nut, hex, 3/4" (for Item 29).
30	Shear pin 3/4" diameter x 4-1/16". Necked in center to 1/2" diameter. Necked in center to 5/8" diameter. Necked in center to 11/16" diameter.
31	Truarc S100-75 Retaining Ring (2 shipped with each shear pin).
32	Bearing adjusting nut, cast steel, 12 TPI (main bearings).
33	Screw, hex head cap, 3/8 x 1" (for Item 32).
34	V-belt sheave.
35	Bolt, hex head, 3/4 x 6-1/2" (sheave to housing).
35-A	Nut, hex 3/4" (for Item 35).
35-B	Lockwasher, spg., Type 3/4" (for Item 35).
36	V-belt.



PELLET MILL PARTS LIST

CONTINUED

<u>ITEM NO.</u>	<u>DESCRIPTION</u>
37	V-Belt sheave (on main drive motor).
39	Belt guard, fabricated.
40	Seal retainer ring, fabricated.
40-A	Screw, SST flat head machine, 1/4 x 3/4".
41	Garlock Style #7066 asb. tape, 1/4 x 3/4 x 78-1/2.
42	Hinged die casing, C.I., with door.
43	Clamp, RH (Feed spout to hinged casing).
44	Clamp, LH (Feed spout to hinged casing).
45	Screw, hex head, 3/8 x 1-1/2" (for Items 43 & 44).
46	Nut, half hex, 3/8" (for Items 43 & 44).
47	Washer, cut, 3/8" (for Items 43 & 44).
48	Hinge pins, 1-1/4" x 6-3/4" (hinged die casing).
51	Inspection door for hinged die casing incl.
52	Hinge, 1-1/2" wide x 11" long.
53	Torit clamp.
54	Collar, 1-1/8" diameter x 5/8" wide, 5/8" bore.
55	Screw, socket head set, 1/4 x 1/4" (for Item 54).
56	Washer, plain 9/16 reamed to 41/64 (for Item 82).
57	Spring, coil (for Item 82).
58	Clamp, 1" x 1" x 2-1/4" keystone (for Item 82).
59	Die.
60	Bolt, hex head, Grade 5, 3/4-10 x 2-1/2" (6" wide die to housing).
61	Washer, hardened 25/32" I.D. x 1-3/8" O.D. x 3/16" thick (all die housing bolts and cover 6" die).
62	Scraper on roller fork.
63	Screw, 316 SST, hex head 3/8" x 1" (scraper blade to fork).
63-A	Washer, 316 SST plain 3/8" (for Item 63).
63-B	Washer, spg. lock, 3/8" (for Item 63).
64	Die stiffener, cast steel.
64-A	Die cover, quick change.
65	Bolt, hex head, Grade 5, 5/8 x 1-1/2 (Item 64 to die).
65-A	Bolt, hex head, Grade 5, 5/8 x 2-1/2 (Item 64-A to die).
65-B	Bolt, hex head, Grade 5, 3/4 x 1-5/8 (6" wide die to stiffener ring).
65-C	Bolt, hex head, Grade 5, 3/4 x 2-1/2 (6" wide die to cover).
67	Screw, square head, 5/8 x 1-1/2" steel (to remove stiffener from die).
68	Motor plate (main drive motor).
69	Motor plate hinge lug.
70	Motor plate eye bolt lug.
71	Motor plate hinge pin.
72	Eye bolt, 30-5/8" long (motor adjusting).
73	Pin for eye bolt.
74	Cotter pin, split #7 x 2-1/2" (for Item 73).
75	Yoke for eye bolt, carbon steel.
75-A	Pin for eye bolt yoke.
75-B	Screw socket head set, 3/8" x 3/4".
76	Nut, hex, 1-1/4" 7 TPI, steel (eye bolt).



PELLET MILL PARTS LIST

CONTINUED

<u>ITEM NO.</u>	<u>DESCRIPTION</u>
77	Bolt, hex head, steel (main motor to pl.).
78	Nut, hex, standard (for Item 77).
79	Shaft seal ring, 5-15/16" O.D. (die pin bearing seal).
80	Cotter pin, split 1/8 x 1" (swing casing to clamp shaft).
81	Handwheel, C.I. (swing casing clamp).
82	Shaft, clamp (swing casing clamp).
83	Roll pin, 1/4" x 1-1/2" (swing casing clamp).
84	Bracket, fabricated (main motor pl. eye bolt).
85	Screw, hex head, 3/4 x 1-1/2" steel (for Item 84).
86	Screw, socket head set, 3/8 x 3/4" (motor pl. hinge pin).
87	Eye bolt, 40" long (motor adjusting).
88	Key, 3/8 x 3/8" x 5-1/2" long (bronze bushing in base).
89	Bolt, hex hd., 5/16"-18 x 1" long.
90	Washer, Lock, 5/16" spg. type.
91	Knife, cut-off
92	Knife holder bar
93	Bracket, Knife (pivoting)
94	Screw, shoulder, 5/8" dia.-11 x 1-1/4" lg., 1/2" thd. x 3/4 lg.
95	Bolt, hex hd., 1/4"-20 x 1-3/4" lg.
96	Washer, 1/4" (plain)
97	Nut, hex, 1/4
98	Base, knife holding
99	Screw, socket hd. cap, 1/2" x 2 lg.
100	Collar, stop
101	Screw, set, sq. hd., 3/8"-16 x 1" lg.
102	Handle, knife holding with knife lock rod, set screw.



PELLET MILL PARTS LIST

<u>ITEM</u>	<u>NO. PCS.</u>	<u>DESCRIPTION</u>
201	2	Knife supports.
202	2	Keys 3/8" x 3/8" x 3-1/2" lg. (in knife supports).
203	2	R.H. mach. screws No. 10-24 thd. 3/4" lg. (keys in supports).
204	16	Cap screws 1/2" x 1-1/4" with L.W. (lugs and bracket to casing).
205	2	Adj. screws for knives.
206	2	Cut-off knives - Ni-Hard.
207	4	Flat hd. mach. screws 5/16" dia. x 5/8" lg. (knives to adj. screws).
208	2	Cranks for knife adjusting screws C.I.
209	2	Crank handles 5/8" dia. x 3-9/16" lg. C.R.S. end threaded.
210	2	Lock nuts C.I.
211	2	Clamp rings 1/4" steel plate.
212	4	Knife support hinge lugs, C.I.
213	12	Cap screws 1/4" dia. x 1-1/8" lg. with L.W. (clamp rings).
214	4	Alemite hyd. fittings 1/8" thd. (for knife supports).
215	2	Knife support hinge pins 3/8" dia. x 5" lg. drill for cotters.
216	4	Cotter pins 3/32" dia. x 3/4" lg. (for hinge pins).
217	2	Knife support latch brackets C.I.
218	2	Plungers C.R.S. .656" dia. x 2-5/8" lg. finished.
219	2	Helical compression springs 7/16" mean dia. x 1-1/2" lg. expanded.
220	2	Spring adjusting screws 3/4" dia. x 1" lg.
221	2	3/4" hex half nuts 16 T.P.I. (spring adj. screw lock).
222	2	Cut-off knives -- carbide tipped. Available on request in place of No. 206.



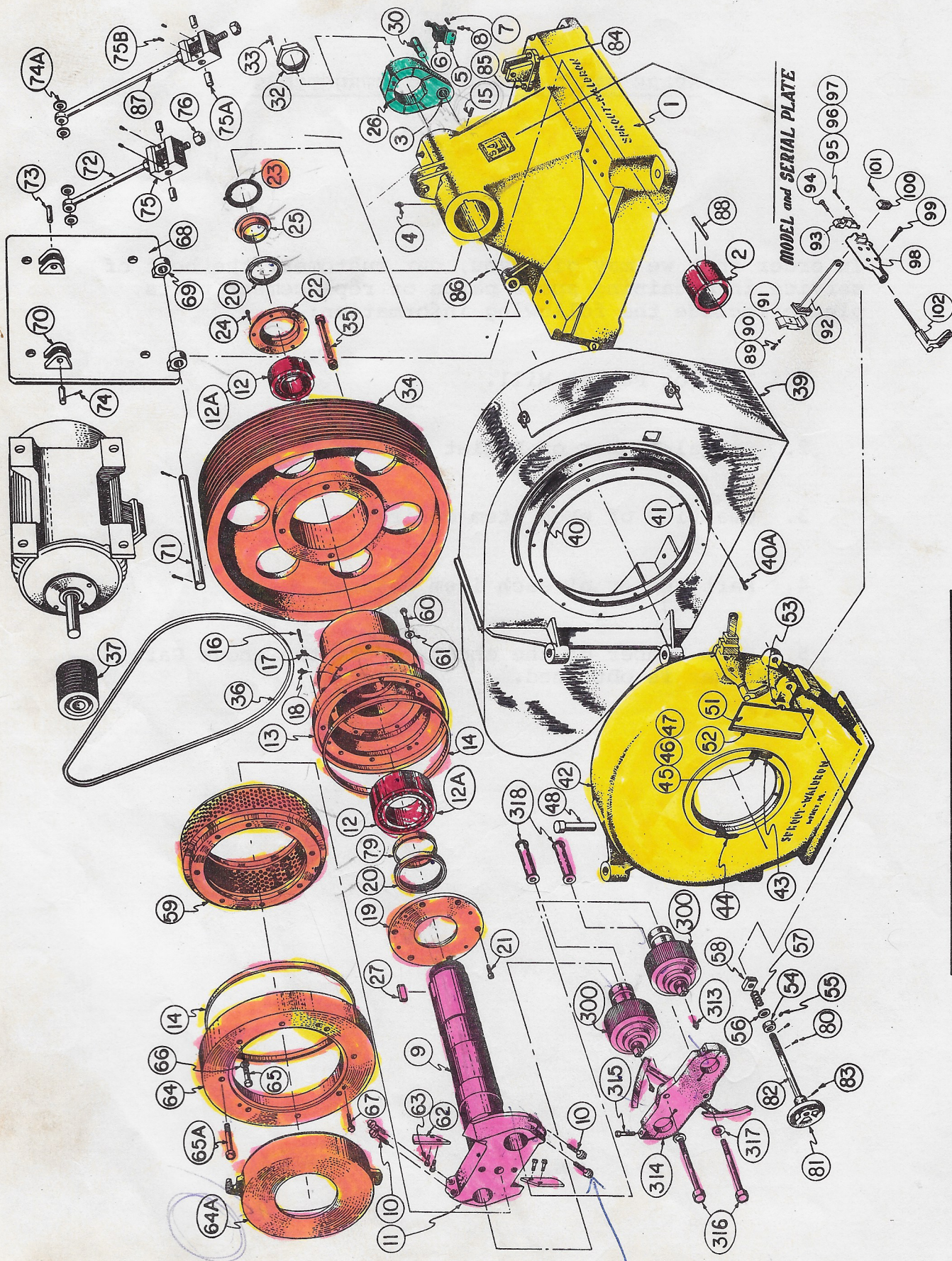

PELLET ACE PARTS DRAWING

F-1337-D



ACE PELLET MILL CUT-OFF KNIFE ASSEMBLY

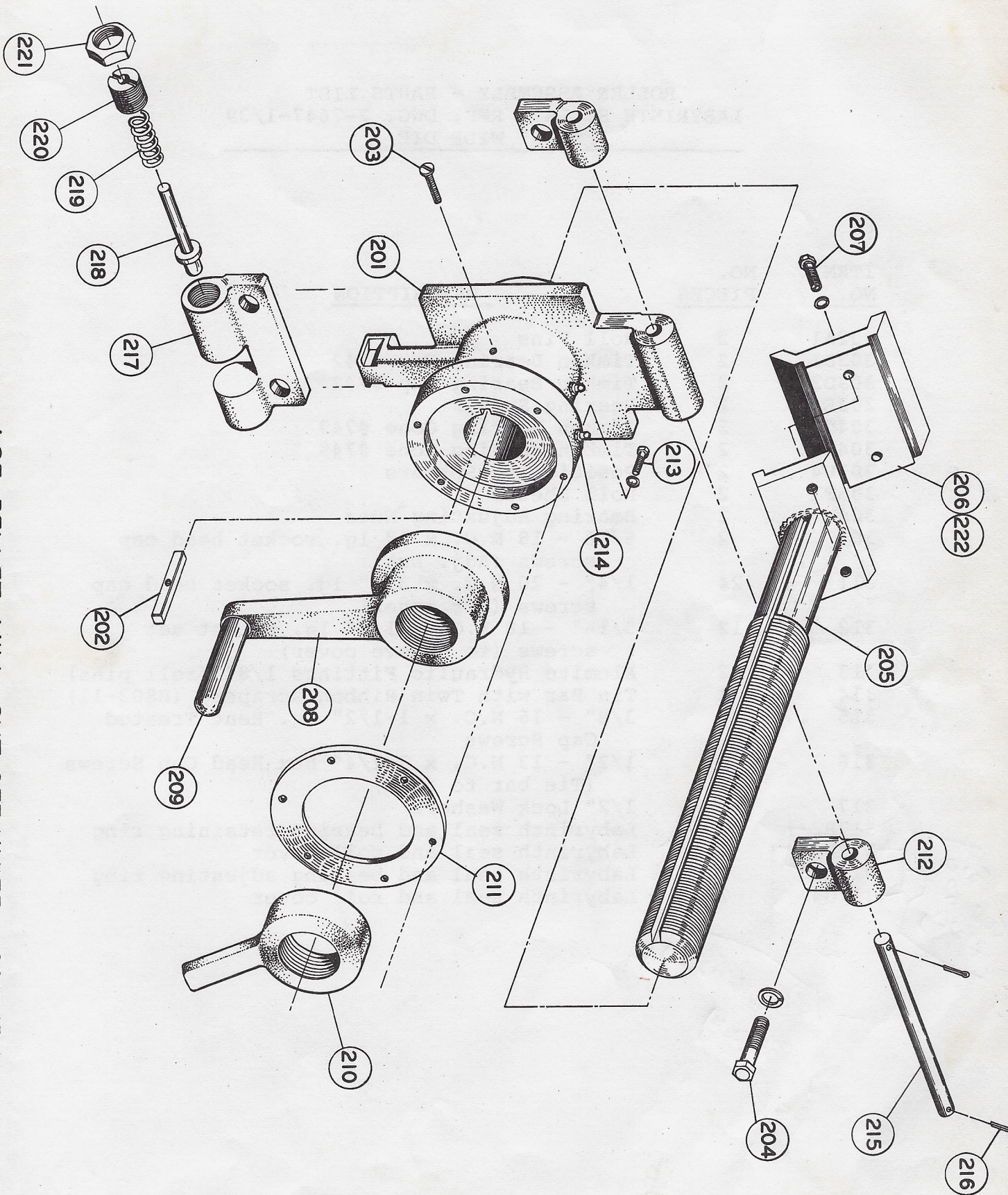



ROLLER ASSEMBLY - PARTS LIST  
LABYRINTH SEALS - REF. DWG. 2-7647-1/39  
FOR 6" WIDE DIE

---

ITEM NO.	NO. PIECES	DESCRIPTION
302A1	2	Roll Pins
303D1	2	Timken Bearing Cup #742
303D2	2	Timken Bearing Cup #742
303E	2	Bearing Spacer
304C1	2	Timken Bearing Cone #749
304C2	2	Timken Bearing Cone #749
305B4	2	Positioning Spacers
305F1	2	Roll Shells
306H	2	Bearing Adjusting Nuts
307	2	5/16 - 18 N.C. x 1" lg. socket head cap screws (Adj. Nut)
311	24	1/4" - 20 N.C. x 3/4" lg. socket head cap screws (for cover)
312	12	5/16" - 18 N.C. x 1/2" lg. socket set screws (to remove cover)
313	2	Alemite Hydraulic Fittings 1/8" (roll pins)
314	1	Tie Bar with Twin Ribbon Scrapers (B803-11)
315	2	3/8" - 16 N.C. x 1-1/2" Lg. Heat Treated Cap Screws
316	2	1/2" - 13 N.C. x 7-1/4" Hex Head Cap Screws (Tie bar to fork)
317	2	1/2" Lock Washers
317B2	2	Labyrinth seal and bearing retaining ring
317B4	2	Labyrinth seal and roll cover
317G2	2	Labyrinth seal and bearing adjusting ring
317G4	2	Labyrinth seal and roll cover

END  
COVER  
ONLY

RETAINING  
RING





## With Labyrinth Seals

**Reference Drawing 2-7647-1/39**

**SPROUT-WALDRON & CO., INC., MUNCY, PA., U.S.A.**